

Assembly of the CR 7 VET Replacement erasure unite



Repair work on the Scanner beyond normal maintenance procedures must only be carried out by Dürr Dental trained and certified professionals or our customer service.

The assembly and user instructions manual for the device must also be followed. This gives important information on safety, set-up, electrical connections, disinfection, cleaning, etc.



Remove the plug before opening the Scanner!

Delivery contents

Erasure unit2137-410-00E

1x Printed circuit board incl. thermal foil

Required tools

SW 2.0 Allen key

SW 2.5 Allen key

Philips screwdriver PH1



- Remove the film tray.

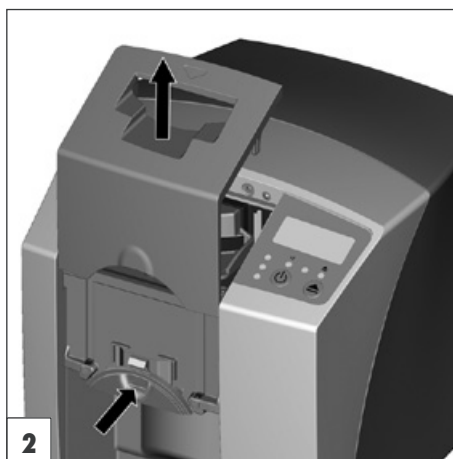

- Press the unlocking button while at the same time lifting the cover up.



- Take out the retaining plate.

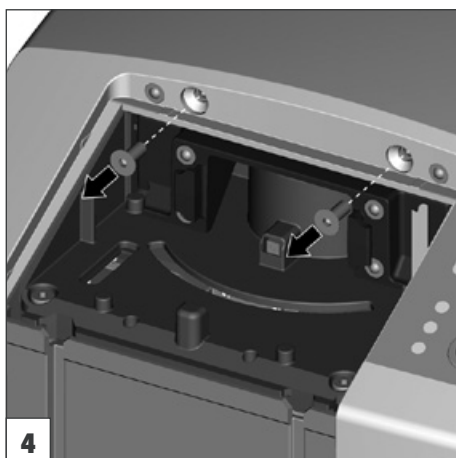

- Remove two countersunk screws with the SW 2.5 Allen key.

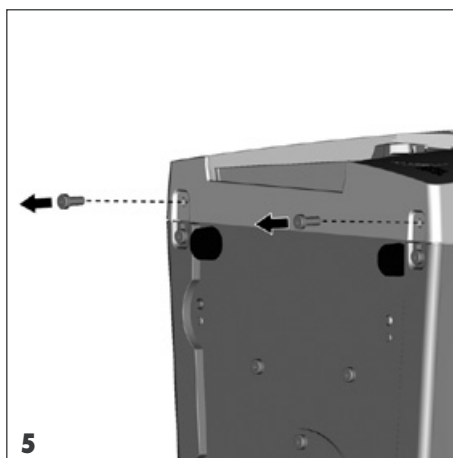

- Remove the socket-head screws underneath with the SW 2.5 Allen key.

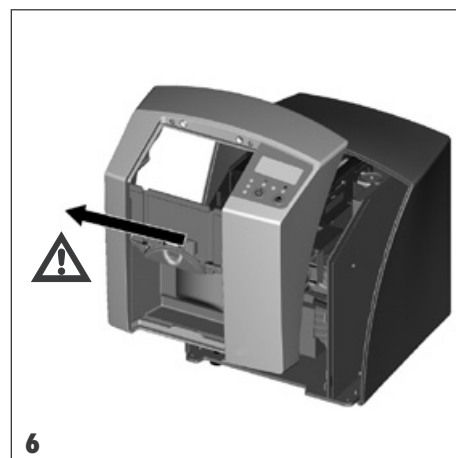

- Lift the front away from the device **very carefully**.



The front is still connected to the device with a ribbon cable. See next step to remove the ribbon cable.

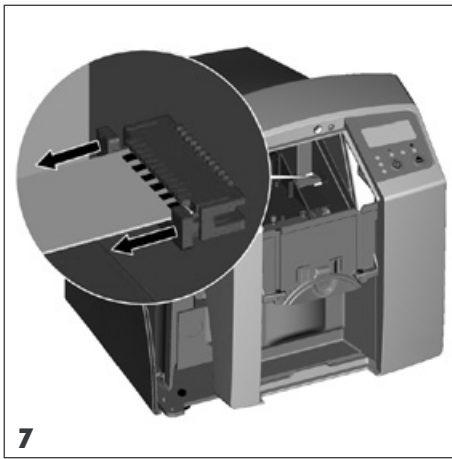

- Unlatch the "Display" socket on the main plate.



The socket is located either at the front or the back of the device depending on the main plate version. If the socket is at the rear of the device, the rear cover must also be removed (four SW 2.5 cylinder screws on the underside; two SW 2.5 counter-sunk screws on the rear).



- Mark the contact positions of the ribbon cable with permanent marker.
- Pull the ribbon cable from the socket.
- Remove the front.

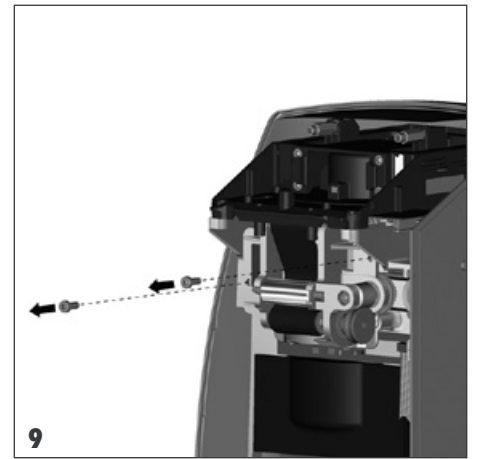

- Remove the sockethead screws from the belt drive with a SW 2.5 Allen key.

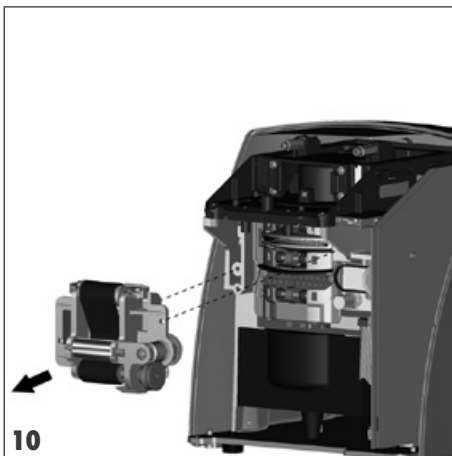

- Remove the belt drive towards the front.

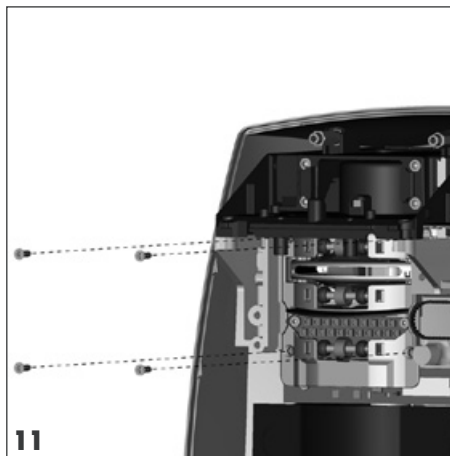

- Use the Phipps screwdriver to remove four counter-sunk screws on the roller locking plate.

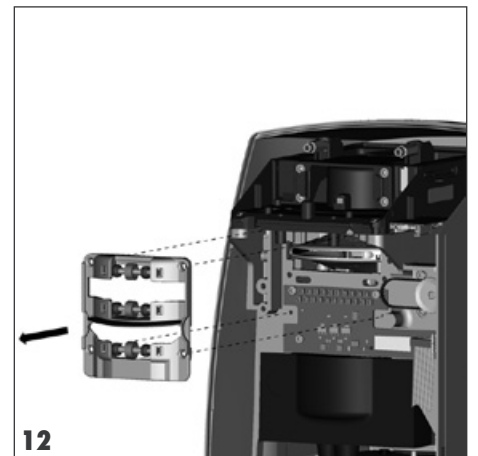

- Pull the plate forwards and outwards to remove.

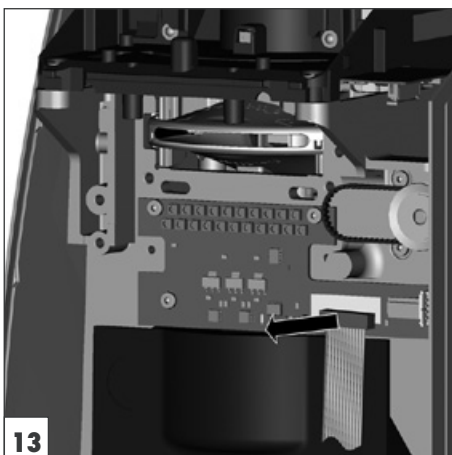

- Mark the position of the connector with a colored pencil, before removing.
- Remove the connector.

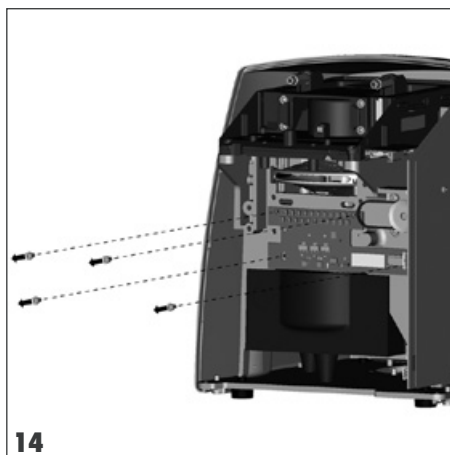

- Remove the four sockethead screws from the erasure unit with a SW 2.0 Allen key.



- Remove the erasure unit.



- Insert the erasure unit.

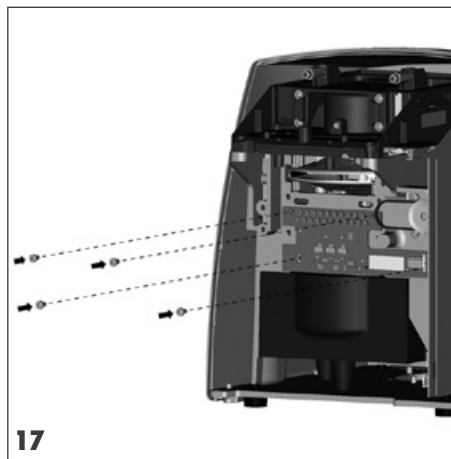

- Fix the erasure unit in place using four socket-head screws and the SW 2.0 Allen key.
- Fix the foam cover below the erasure unit.

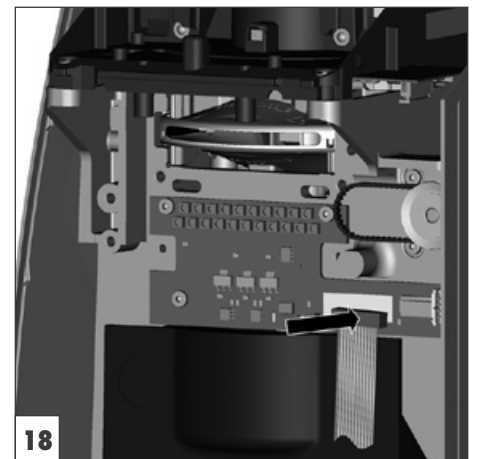

- Replace connector



Check the mark!

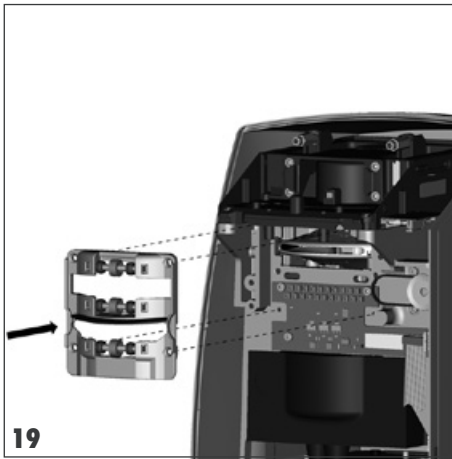

- Insert the roller locking plate.

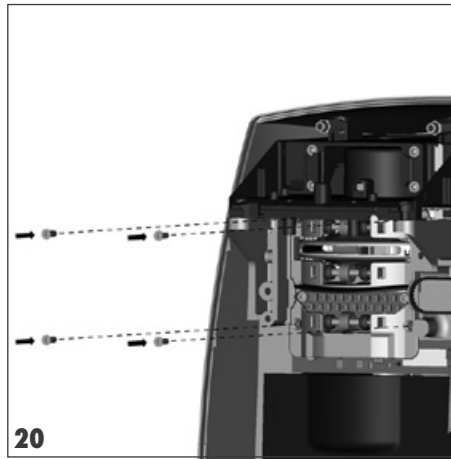

- Fix the plate in position using four counter-sunk screws and Philips screwdriver.

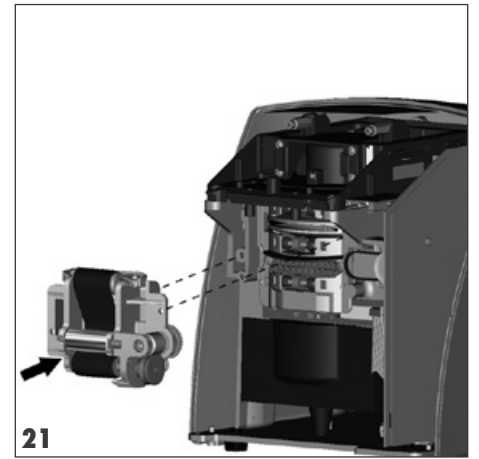

- Place belt drive in position.



The drive belt must be pulled over the belt coupling of the motor and the belt drive when placed in position.

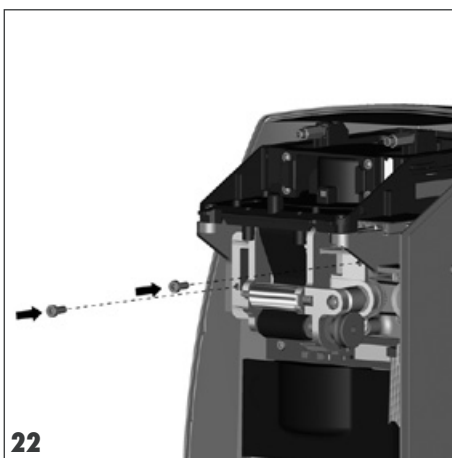

- Fix the belt drive in position using two sockethead screws and a SW 2.5 Allen key.



- Put the front in place.
- Put the ribbon cable into the socket.



Check the position of the contacts!



- Latch the socket.



25

- Put the front into place.



The ribbon cable must be placed in such a way that it won't be crushed or damaged preventing it from working correctly.

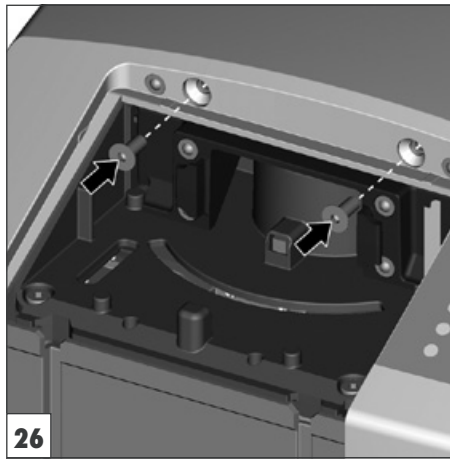

26

- Insert two countersunk screws with the SW 2.5 Allen key.

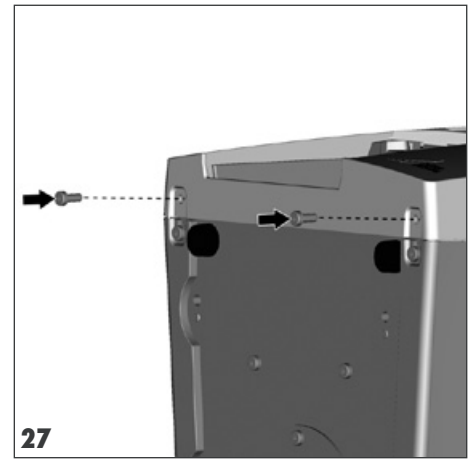

27

- Insert two cylinder screws on the underside with a SW 2.5 Allen key.

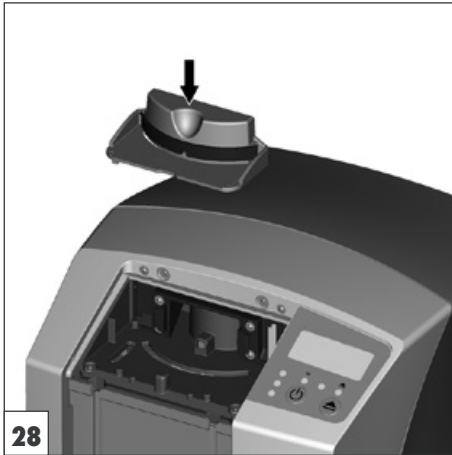

28

- Insert the retainer.

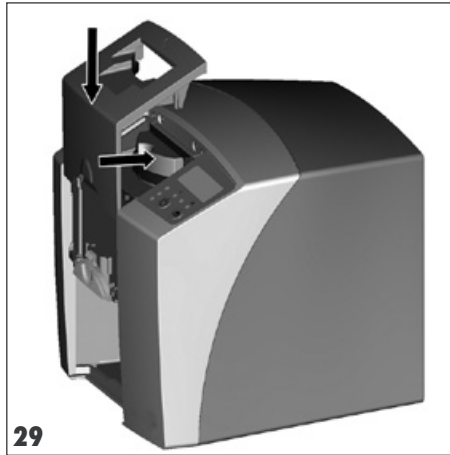

29

- Click the retainer into place in the device and put the cover back into place at the same time.



30

- Put back the film tray.

Test 1:

- Switch unit on.
- Monitor the initialisation sequence (text is displayed on panel clearly, locking plate moves, drive starts, erasure unit lit).



There must be no unusual noises and nothing should appear on the display which are not expected from the unit.

Test 2:

- Expose an image plate with an object (e.g. a key).
- Scan the exposed image plate with erasure unit switched on.



The scanned image will be deleted.

- Scan the same image plate evenly homogeneously exposed.



There must be no signs of artefacts or irregularities (e.g. ghost images, shadows).

DÜRR NDT GmbH & Co. KG

Division DÜRR MEDICAL
Höpfheimer Straße 22 · 74321 Bietigheim-Bissingen, Germany
Tel: +49 7142 99381-0 · Fax: +49 7142 99381-299
info@duerr-medical.de · www.duerr-medical.de

9000-608-83/01



2012/02/20

